

DORMAN SMITH

# MHFS200X3

MODIS 12  
ULTRA

## HOUSING FOR 3 X 200A FUSE SWITCH

### FITTING INSTRUCTIONS

SHEET 1 OF 2

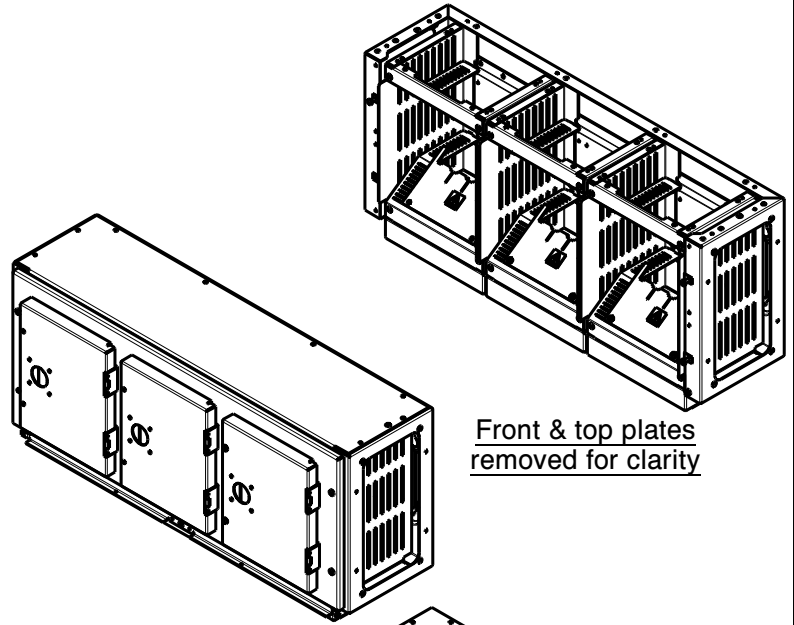
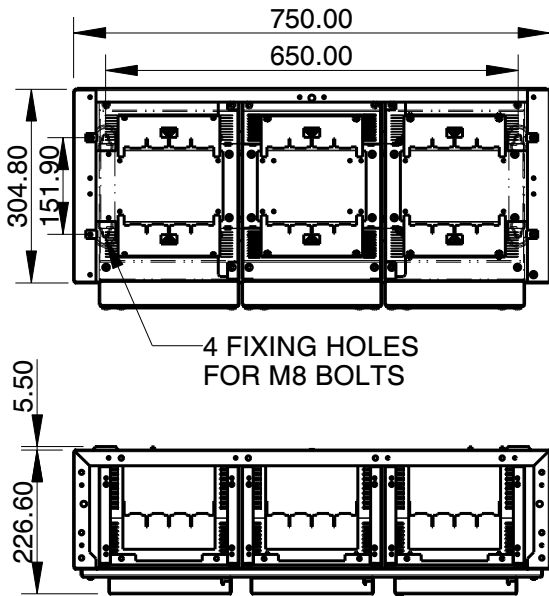

**NOTE:-** Unit is shown as supplied.  
Fuse switches and busbar connections are supplied separately under catalogue numbers shown on sheet 2.

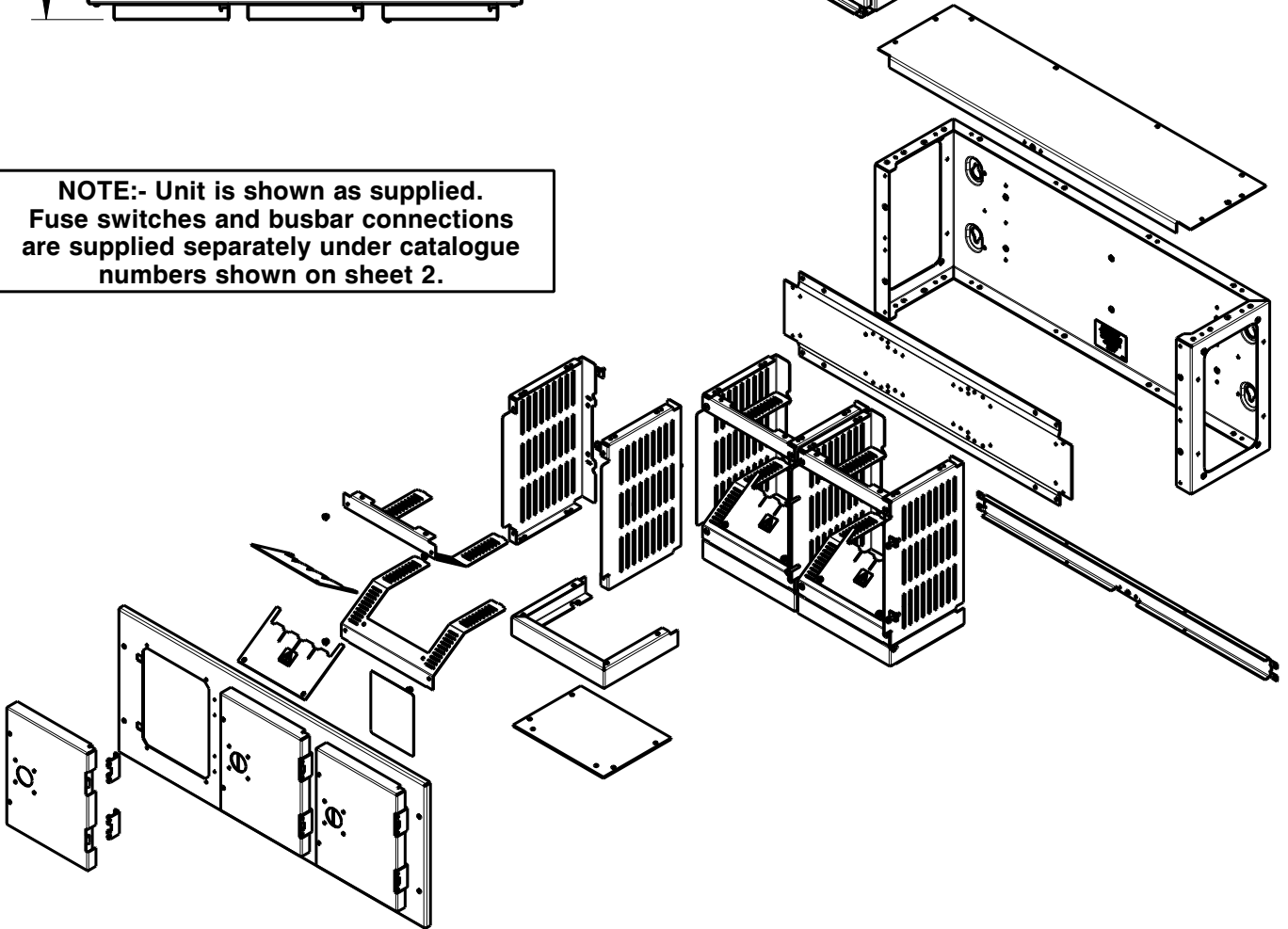

#### TESTING AND COMMISSIONING

Before the unit and the installation of which it forms a part are commissioned they must be tested, in accordance with the requirements of the latest edition of the Requirements for Electrical Installations.

Installation and operation must be in accordance with published data, instructions and diagrams and any relevant national and local regulations



## HOUSING FOR 3 X 200A FUSE SWITCHES

### FITTING INSTRUCTIONS

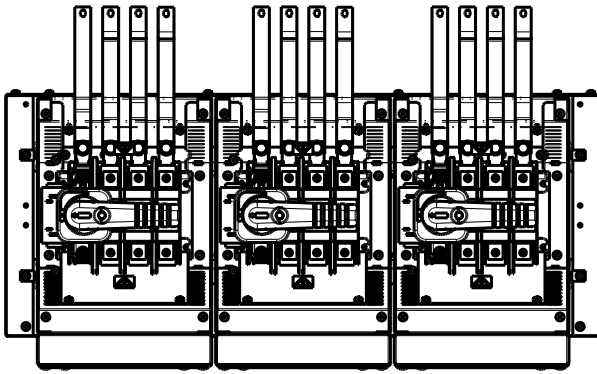

Front plates removed and shrouds dimmed for clarity

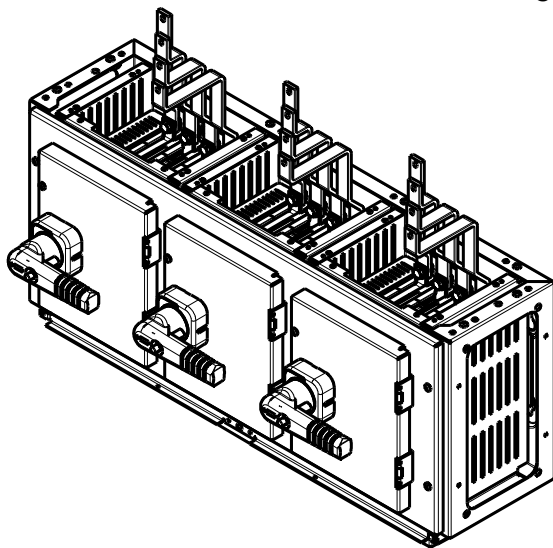

BUSBAR CONNECTIONS - MCFS200

200A FUSE SWITCH - REFER TO CATALOGUE FOR NUMBERS & ACCESSORIES

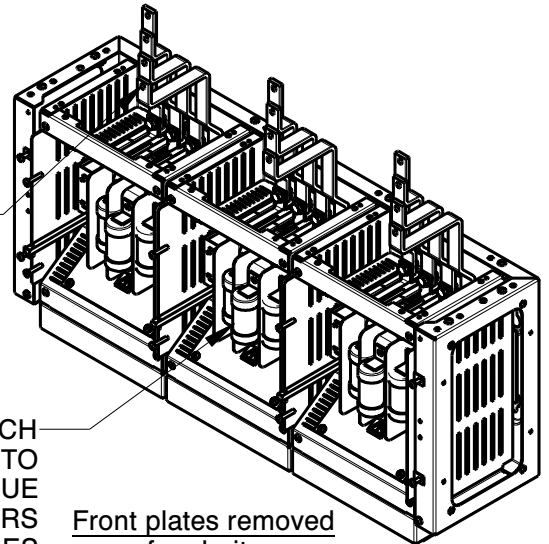

Front plates removed for clarity

### FITTING FUSE SWITCHES AND CONNECTIONS

**NOTE:** Enclosure can be mounted above or below the horizontal busbars.

- 1) Remove all front/end plates and shrouds and fix the unit to the wall using suitable bolts (not supplied).
- 2) Bolt the unit to the horizontal busbar housing using the M6 x 16 bolts and washers supplied in the cross strap fastener kit.
- 3) Mount the fuse switch to the mounting plate using the screws supplied with the connection kit.
- 4) Fit the connections between the fuse switch and busbars. Instructions and all fasteners are supplied with the kit.
- 5) Install incoming cables using appropriate cable glands and sockets. To avoid swarf and other foreign objects entering the enclosure always remove gland plates to cut cable / trunking entries.
- 6) Check the tightness of all connections and refit top and bottom shrouds.
- 7) If any of the ways are unused fit kit LFXHBA (supplied separately) to cover the handle hole and fit the black insulation to the shroud at the busbar end of the unit to block access to the busbars.
- 8) Use the earth kit required to attach earth connection to either end of unit as required.
- 9) Refit cross straps and front plates. **NOTE:** Before fitting the front cover check the tightness of connections and ensure that all shrouds are correctly located and secured in place.

#### RECOMMENDED TORQUE FIGURES (unless otherwise stated)

SIZE	M5	M6	M8	M10	M12	M16
TORQUE Nm	5.5	9.5	17	28	45	91

