

UNIT CONTENTS

The following are supplied with each MCB Board

- 2 x Earth/Neutral cable clamps
- Dolly cover catch
- Way market label
- On/Off label
- Instruction Leaflet



LOADLIMITER 63

GENERAL INSTALLATION

Storage prior to installation must be in clean dry conditions.

INSTALLATION PROCEDURE

Installation and operation must be in accordance with published data, instructions and diagrams and with any relevant national and local regulations.

STANDARD TP&N DISTRIBUTION BOARDS

- 1 Remove door and front plate assembly by removing 4 fixing screws. Remove any additional front plates if fitted.
- 2 Remove end plate by slackening 4 screws and sliding plates forward off keyhole fixings (no need to remove screws fully).
- 3 If preferred, remove pan assembly by slackening 4 screws and lifting off keyhole fixings.
- 4 Fit incoming switch disconnecter if required (see details on reverse).
- 5 Hang enclosure on wall using top keyhole fixings on 398mm horizontal centres.
- 6 Secure with two screws in bottom keyhole fixings.
- 7 Drill end plates to accept incoming and outgoing cable glands (note: centre punch indent in end plate gives position for largest gland).
- 8 Fit MCBs as described below, replace pan and end plates.
- 9 Install incoming and outgoing cables (see details on reverse for Neutral and Earth connections).
- 10 Identify circuits on way marker label and attach to front plate matching phase orientation with busbar.
- 11 Refit door and front plate assembly.

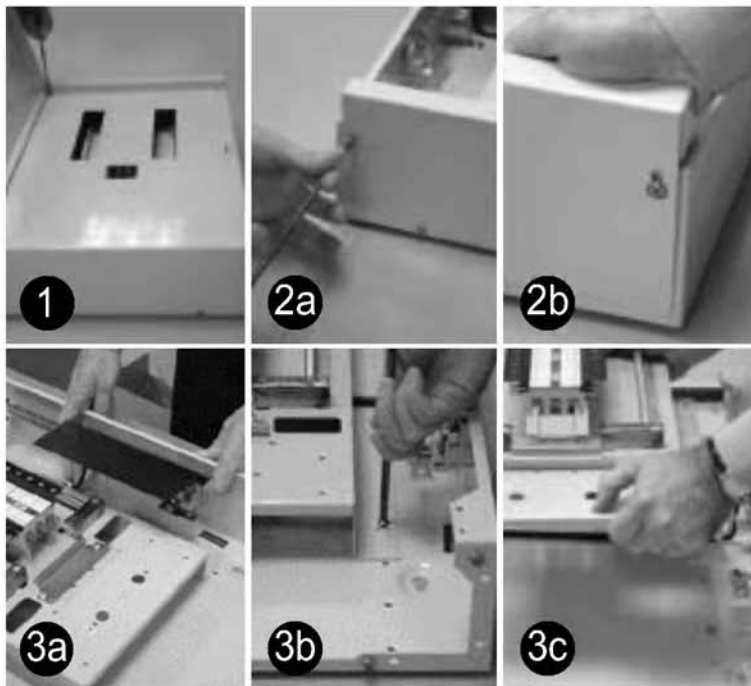

FITTING AND REMOVAL OF MCBs - Fitting

- 12 Ensure supply is isolated.
- 13 Fully slacken all MCB terminal screws.
- 14 Install all MCBs locating terminal screws into forks on busbar stems, but without tightening screws (Ensure MCBs are correctly positioned with terminal screws accessible through holes in cover extrusion).
- 15 Tighten individual MCB terminal screws while simultaneously pushing MCB towards busbar, ensuring busbar stem locates positively against pocket of terminal screw on MCB
- 16 Fit busbar terminal blanks as shown on unused ways. Shrouds supplied separately with front plate blanking strips, catalogue number DBXBP, DBXBM, DBXBH or DAXTP

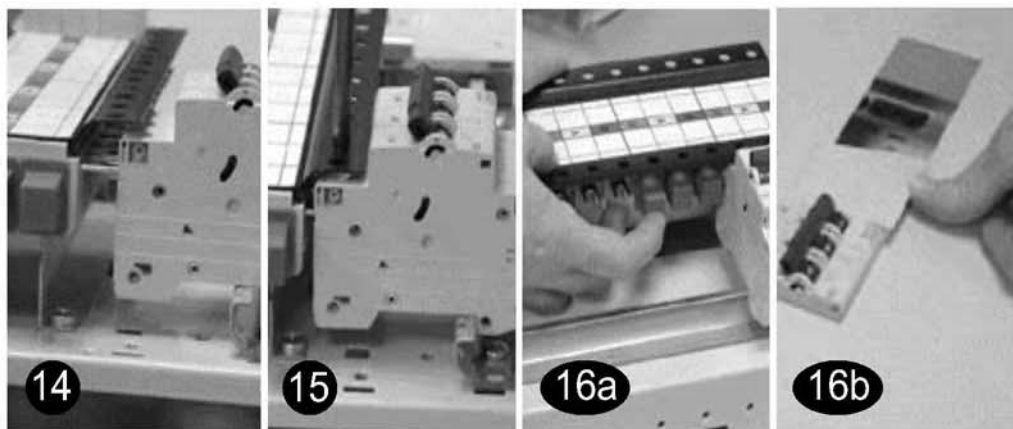

Note: Install MCB with white DIN rail clip facing busbar (i.e.) MCB switches 'off' towards busbar.

Removal

- 17 Ensure supply is Isolated.
- 18 Slacken terminal screws on MCBs to be removed (pic 15 above).
- 19 Remove MCBs by pulling away from busbar

INCOMING CONNECTIONS - Neutral/Earth

Separate neutral/earth bars are provided on either side of busbar to simplify cabling. The left hand set has the earth bar at the bottom while the right hand set has the neutral at the bottom. Neutrals are linked by an insulated bar .

- 20 Remove black shroud from right hand neutral bar to give access to incoming terminal.
- 21 Connect incoming neutral using either 6mm hole for crimp connector, or 150mm² cable clamp (supplied).
- 22 Connect incoming earth to terminal on left hand earth bar using either 6mm hole for crimp connector, or 150mm² cable clamp supplied.
- 23 For Clean Earth connection, remove the M6 stud from the lower left hand earth bar. The upper right hand earth bar must remain as a standard earth.
- 24 Connect outgoing neutral/earth cables so that numbered positions on bars correspond with MCB way numbers.

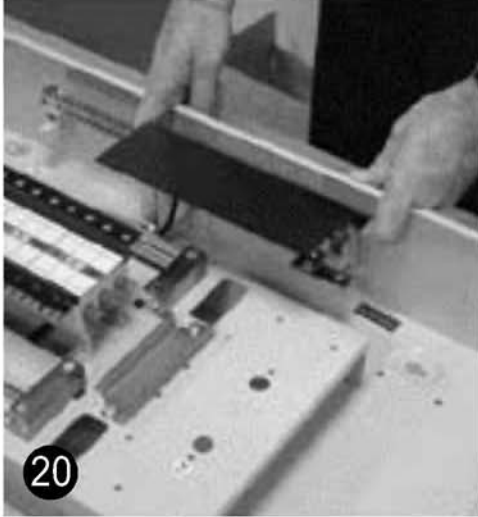

SWITCH DISCONNECTOR INSTALLATION

- 25 Remove short mounting rail by slackening both screws.
- 26 Fully slacken Switch Disconnecter terminal screws.
- 27 Fit switch Disconnecter to rail.
- 28 Offer up to busbar ensuring stems fully locate into Switch Disconnecter terminals.
- 29 Tighten mounting rail screws.
- 30 Tighten Switch Disconnecter terminal screws.
- 31 Attach switch disconnecter ON/OFF label to right of cut-out in front plate.

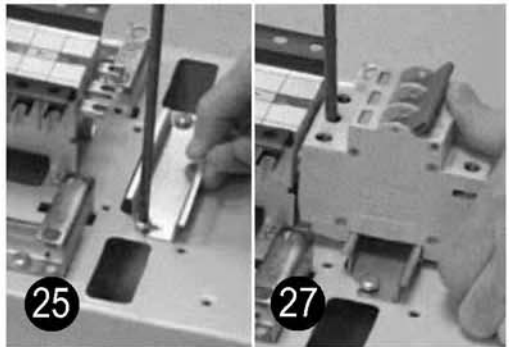

Direct Connection/RCCB Control

See leaflets supplied with each connection kit.

MAINTENANCE

Maintenance must be carried out by competent personnel **WITH THE SUPPLY ISOLATED**. However no maintenance of the unit is required except for the periodic checking of the tightness of the terminals. All electrical connections should be correctly aligned, tightened and checked against the following torque figures.

- M4 - 1.35Nm M5 - 5.5Nm M6 - 9.5Nm M8 - 17Nm M10 - 28Nm M12 - 45Nm M16 - 91Nm

We recommend that you retain this sheet and store it within the distribution board for future reference.

INSTALLER'S CHECK LIST

- Are the MCB's correctly fitted and secure ?
- Is the incoming device correctly fitted and secure ?
- Have the busbar terminal blanks and MCB blanking pieces been fitted to all spare ways ?
- Have all electrical connections been checked for tightness ?
- Has the cover plate been securely replaced ?
- Are all circuits adequately identified ?