

800A FORM 4 YA3/YB3 MCCB PANELBOARD
FITTING INSTRUCTIONS

SHEET 1 OF 2

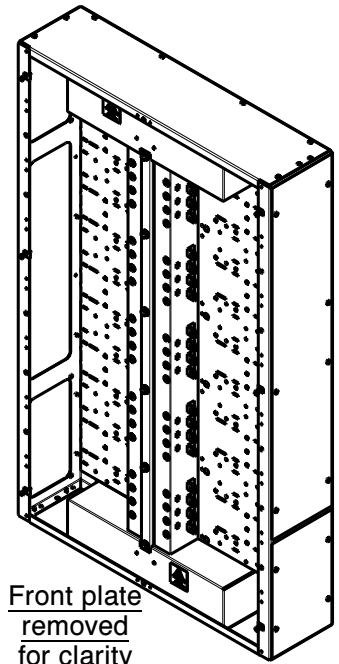

CAT NO,	DIM, A	DIM, B	DIM, C	FIXINGS
LF806YA3	762.0	609.10	--	4
LF810YA3	1219.20	1066.30	533.15	6

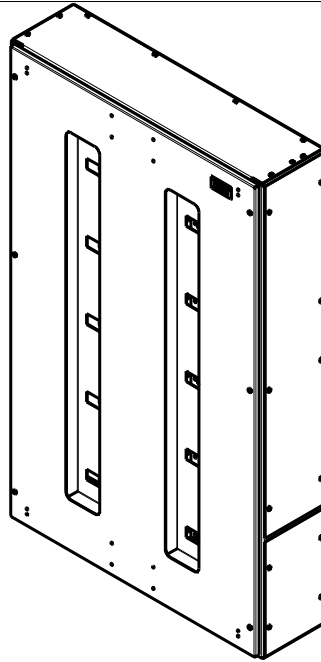
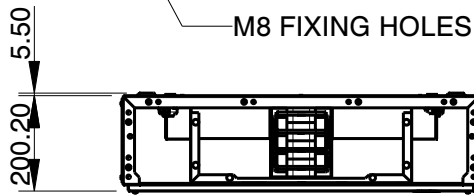
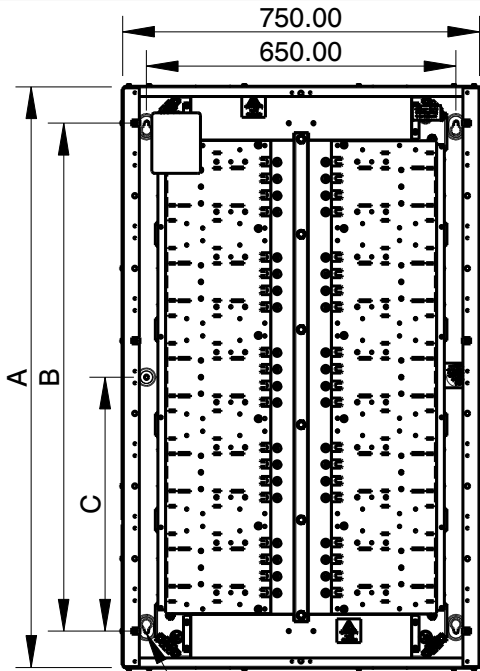
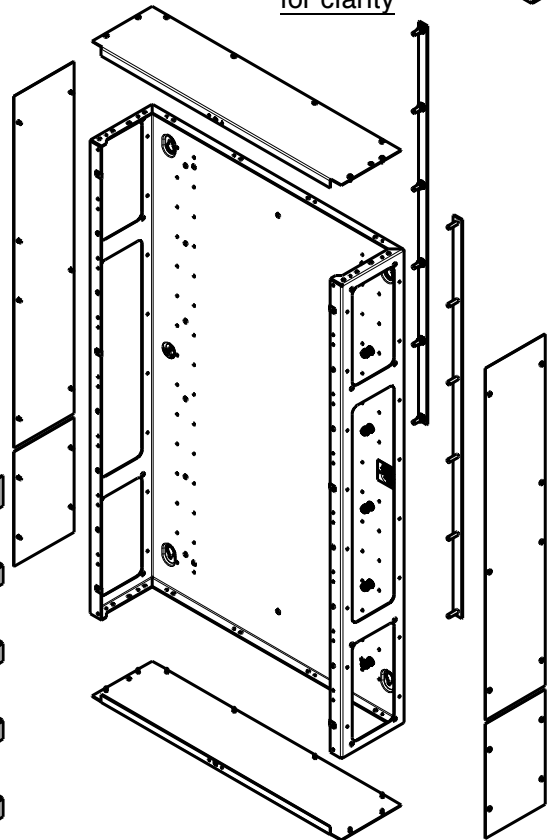
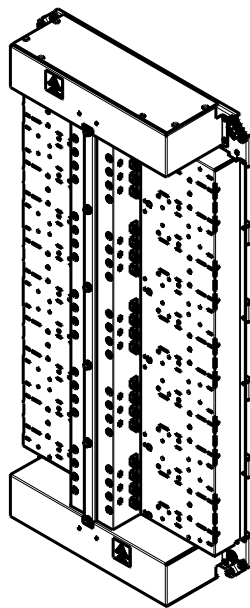

Form 4 end shroud and cross connector moulding per outgoing way are supplied loose in unit along with required fastener kits

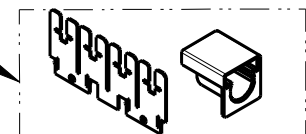

Installation and operation must be in accordance with published data, instructions and diagrams and any relevant national and local regulations

800A FORM 4 YA3/YB3 MCCB PANELBOARD
FITTING INSTRUCTIONS

SHEET 2 OF 2

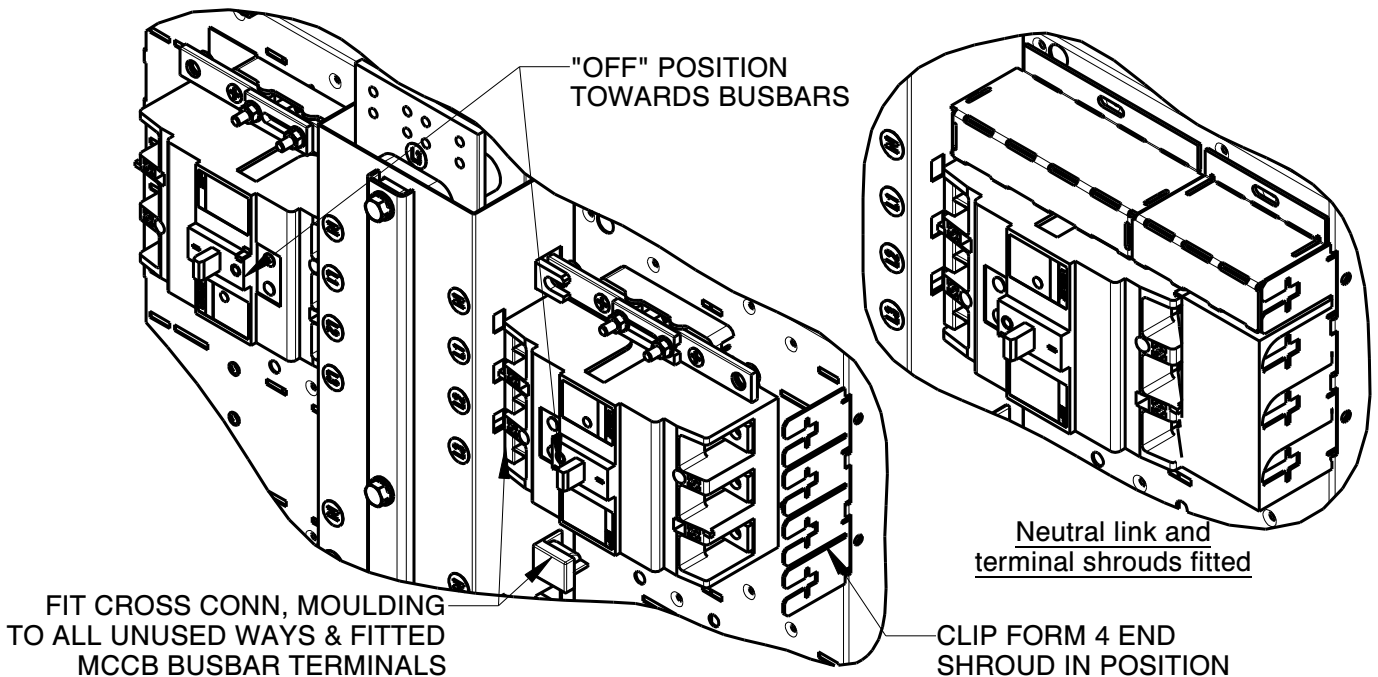
TESTING AND COMMISSIONING

Before the unit and the installation of which it forms a part are commissioned they must be tested, in accordance with the requirements of the latest edition of the Requirements for Electrical Installations.

FITTING ENCLOSURE

- 1) Remove all front/end plates and fix the unit to the wall using suitable bolts (not supplied).
- 2) Enclosures for incoming devices or horizontal busbars may be fitted above or below the unit. Refer to the relevant catalogue for a full list.

FITTING DEVICES

- 1) Ensure supply to the unit is switched off before removing front plate.
- 2) Align the MCCB to the terminals with the "OFF" position towards the busbars as shown above, taking care with the phase orientation, and fasten to the mounting plate with the screws supplied with the MCCB.
- NOTE:** 4 pole devices can be fitted to the left hand side of the panel only.
- 3) If a neutral link is required use cat. no. YA3F4NL fitted in position as shown above.
- 4) Fully tighten the busbar connections. Refer to instructions supplied with MCCB for torque figures setting details and additional information concerning the MCCB.
- 5) Clip the supplied clear plastic form 4 end shroud into the mounting plate.
- 6) Install incoming cables using appropriate cable glands and sockets and run cables through the slots in the form 4 end shroud. Slots may need to be enlarged for larger cables. To avoid swarf and other foreign objects entering the enclosure always remove gland plates to cut cable / trunking entries.
- 7) Slide cable lug terminal shroud, cat no. YA3TS3P, YB3TS3P, (3 pole) or YA3TS4P, YB3TS4P (4 pole), onto the end of the MCCB and down over the cables ensuring that the form 4 end shroud locates into the slot in the shroud.
- 8) **NOTE:** All unused outgoing ways & the busbar terminal screws of fitted MCCBs must be fitted with cross connection mouldings supplied. Unused ways in front plate can be blanked off using supplied blanks.
- 9) Use the earth kit required to attach earth connection to either end of unit as required.
- 10) Refit cross straps and front plates.

RECOMMENDED TORQUE FIGURES

SIZE	M5	M6	M8	M10	M12	M16
TORQUE Nm	5.5	9.5	17	28	45	91