

**Motor Operator
Operator Instruction
Manual**

Types: YA2MA110
YA2MA240
YA3MA110
YA3MA240

Please retain this manual for future reference. The Manufacturer assumes no responsibility for damages resulting from non-application of the instructions provided herein.

Dorman Smith Switchgear Limited
8 Swinbourne Drive
Springwood Industrial Estate
Braintree Essex
CM7 2YG UK
Tel: +44 (0) 844 225 1063
Fax: +44 (0) 844 225 1064

KRB-0334b

1 Applicable Breaker Type

Motor Operator Type	Applicable Breaker Type
YA2MA***	YA2
YA3MA***	YA3

2 Packaged Items

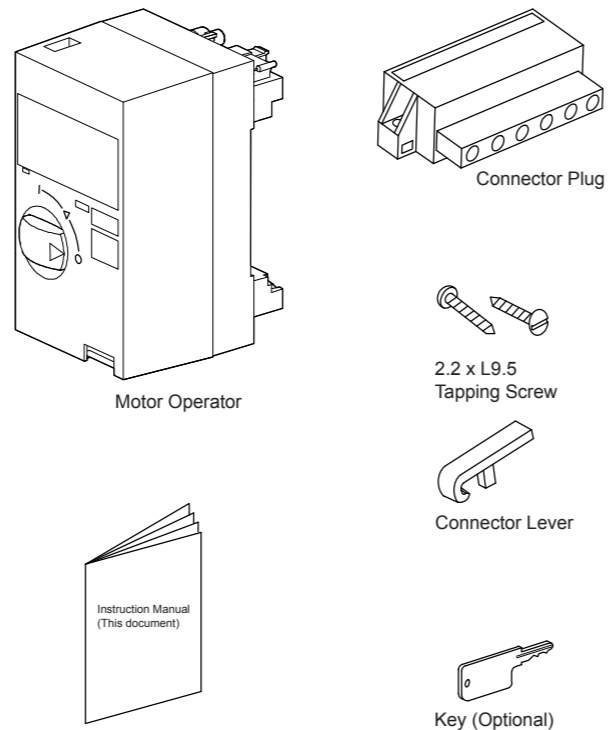

3 Safety Notices

Be sure to read these instructions and other documents accompanying this product. Please familiarise yourself with handling of this product, safety information, and all other precautions before mounting, using, servicing or inspection. In these instructions, safety notices are divided into "Warning" and "Caution" according to the hazard level.

⚠ WARNING A warning notice with this symbol indicates that neglecting the suggested procedure or practice could result in lethal or serious personal injury.

⚠ CAUTION A caution notice with this symbol indicates that neglecting the suggested procedure or practice could result in moderate or slight personal injury and/or property damage.

Note that failing to observe **⚠ CAUTION** notices could result in serious results in some cases. Because safety notices contain important information, be sure to read and observe them.

⚠ WARNING

Operation Precautions

1. Never touch live terminals. Doing so may result in electric shock

⚠ CAUTION

Installation Precautions

1. Installation work must be performed by competent persons.
2. Prior to commencing any work on the product, open an upstream circuit breaker or the like to isolate all sources of power/voltage. Otherwise electric shock may result.
3. Do not touch the handle catch on the back of the Motor Operator. Doing so may cause personal injury.
4. Be sure to connect terminal E to ground. Otherwise electric shock may result.
5. Do not remove the cover of the Motor Operator. Doing so may cause personal injury.

⚠ CAUTION

Operation Precautions

1. When the breaker trips open automatically, remove the cause; then close the breaker. Otherwise, a fire could result.

Motorised Operation Precautions

1. Permissible ranges of operating voltage are as follows:
AC 85 to 110% of the rated voltage
DC 75 to 110% of the rated voltage
Undervoltage or overvoltage may cause burnout.
2. The motor is rated for short-time. Repeated open/close operation should not exceed 10 times. Otherwise, burnout could result.
3. If the breaker does not open/close within three seconds after operation, turn off the operating voltage. Otherwise, burnout could result.
4. The dielectric withstand voltage of the Motor Operator is 1500 VAC for one minute between the control circuit group and terminal E. (for control voltage of 24 VDC, the dielectric withstand voltage is 500 VAC for one minute). Overvoltage may result in damage to the Device.
5. Please do not use the Motor Operator outwith the relevant breaker. Otherwise, damage may occur.

Manual Operation Precautions

1. Do not apply excessive force to the operating knob. Otherwise, damage may occur.

■ Other Precautions

1. The motorised operation is possible only at the time of the illumination of the power supply indication lamp. Light up the power supply indication lamp, by drawing the operation knob first and pushing in once again, when the power supply indication lamp is turning off.
2. Be sure to pull out the operating knob when performing manual operation.

4 Mounting1

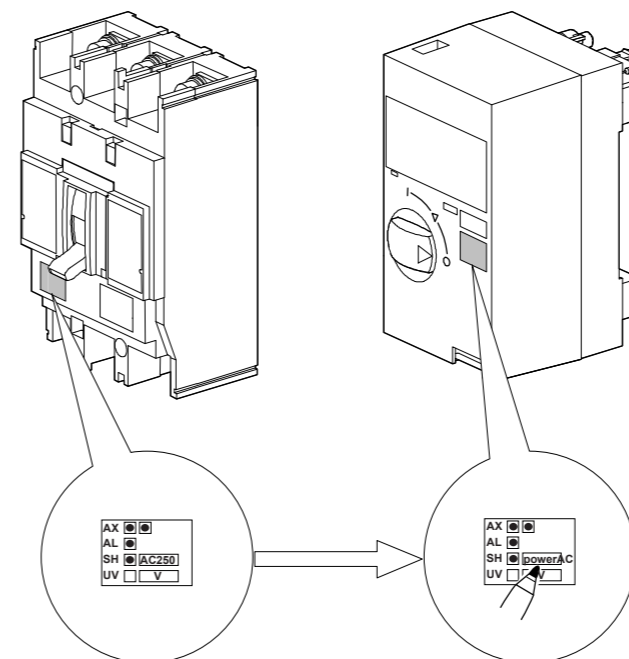

5 Mounting2

Complete breaker installation and wiring before mounting the Motor Operator. Otherwise, complete installation and wiring is not possible.

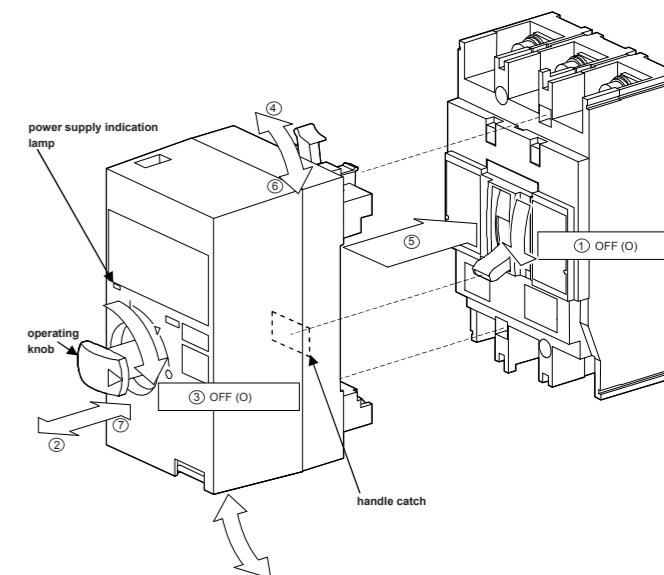

6 Mounting3

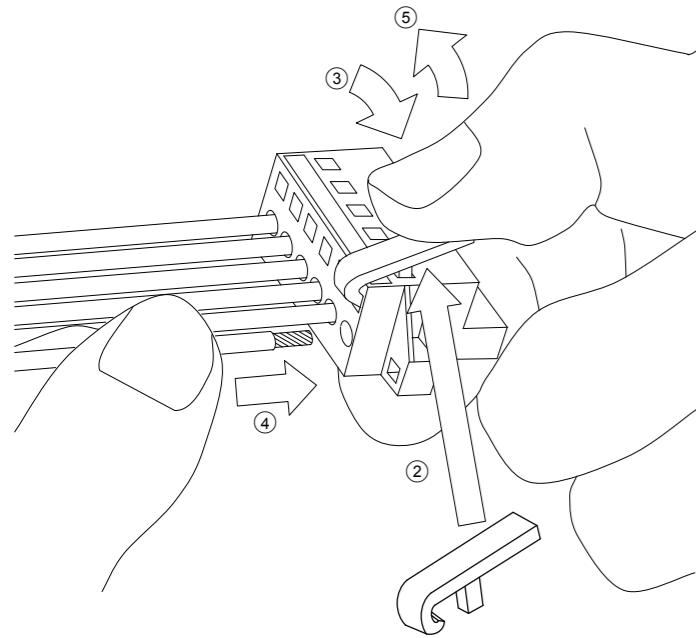
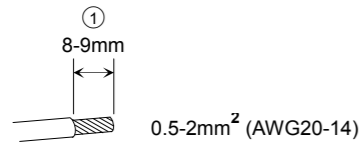

7 Mounting4

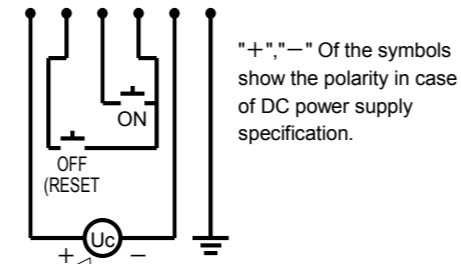
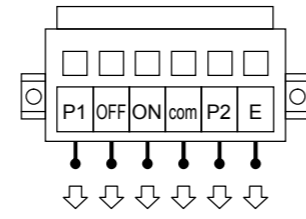

Connect indicated source voltage(Uc).

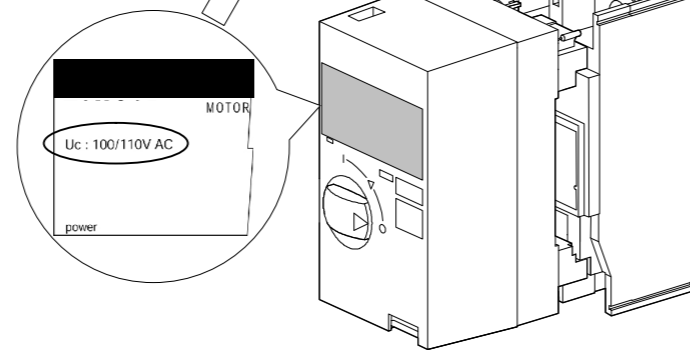

8 Mounting5

Execute the electric wires such that the load does not hang to the connector plug with such a method that the electric wires unites to the structure.

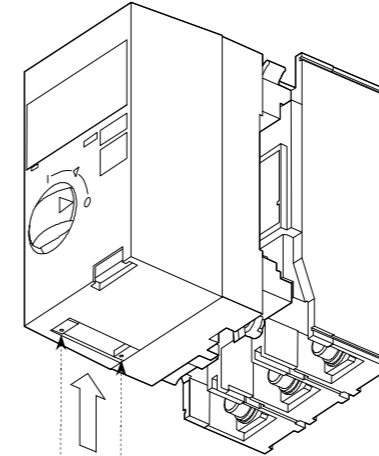

φ 2.2 × L9.5 0.13-0.15N·m
Use if installing the Motor Operator in an area that is subject to strong vibrations.

After mounting, verify the function of the Motor Operator.

9 Removal

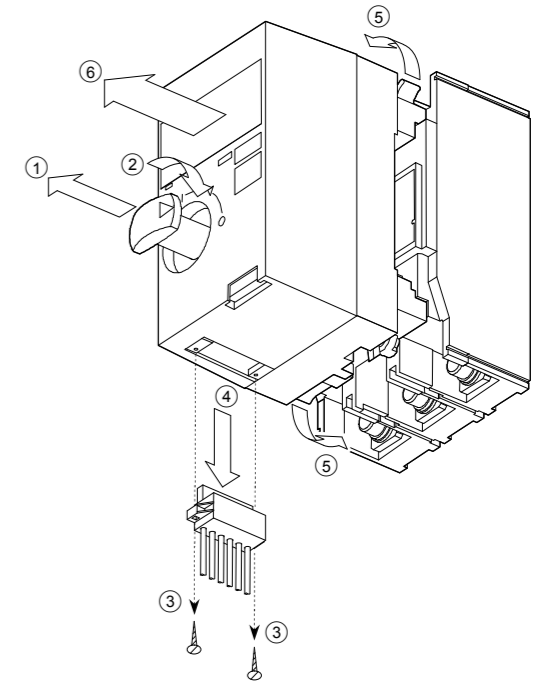

10 Motorized Operation

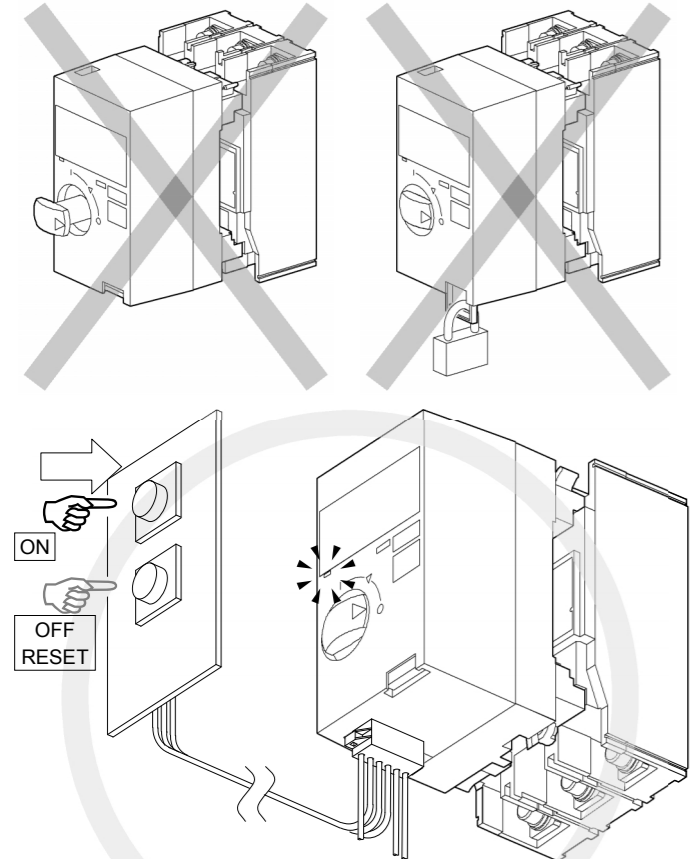

When the breaker trips from OFF condition, reset the breaker by pushing the ON button then pushing the OFF button.

11 Manual Operation

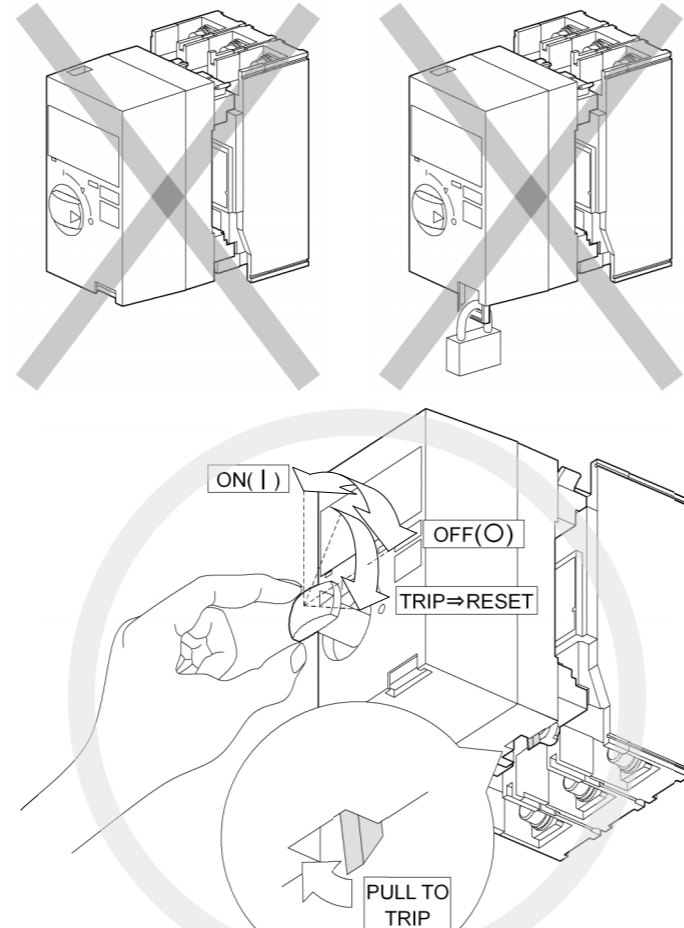

12 Lock-in Off Operation(Standard)

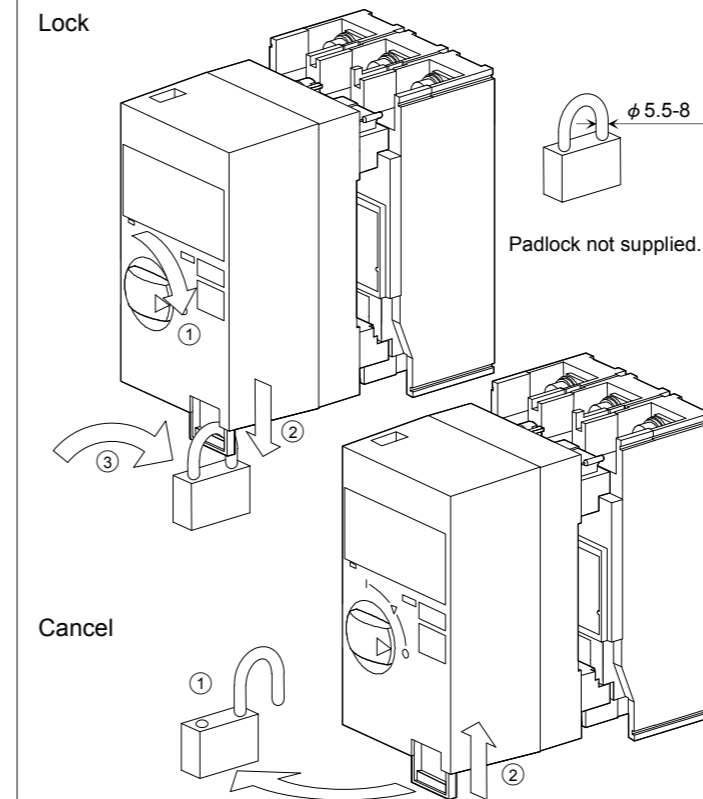

13 Lock-in Off Operation by key (Optional)

